

Licensing Sub-Committee Report

Item No:	
Date:	27 th June 2016
Licensing Ref No:	16/03431/LIPN - New Premises Licence
Title of Report:	28A Leicester Square London WC2H 7LE
Report of:	Director of Public Protection and Licensing
Wards involved:	St James's
Policy context:	City of Westminster Statement of Licensing Policy
Financial summary:	None
Report Author:	Mr Darren O'Leary Senior Licensing Officer
Contact details	Telephone: 02076417824 Email: doleary@westminster.gov.uk

1. Application

1-A Applicant and premises			
Application Type:	New Premises Licence, Licensing Act 2003		
Application received date:	5 April 2016		
Applicant:	DC Bars Limited		
Premises:	28A Leicester Square		
Premises address:	28A Leicester Square London WC2H 7LE	Ward:	St James's
		Cumulative Impact Area:	West End
Premises description:	Cocktail Bar in the basement of the premises.		
Premises licence history:	<p>This premise currently holds a licence 11/07005/LIPDPS. Please see appendix 3 for a full licence history.</p> <p>This application is to effectively reduce the hours of licensable activities and increase the premises capacity.</p> <p>Please see applicant submissions in appendix 2 for a version of the proposed licence.</p>		
Applicant submissions:	None.		

1-B Proposed licensable activities and hours							
Recorded Music, Live Music, Performance of dance, Anything of a similar description to that above, Private Entertainment consisting of dancing, music or other entertainment of a like kind for consideration and with a view to profit:				Indoors, outdoors or both			Indoors
Day:	Mon	Tues	Wed	Thur	Fri	Sat	Sun
Start:	09:00	09:00	09:00	09:00	09:00	09:00	09:00
End:	01:45	01:45	01:45	03:45	03:45	03:45	01:15
Seasonal variations/ Non-standard timings:	<p>These hours to be extended from the end of permitted hours on New Year's Eve to the start of permitted hours on New Year's Day.</p> <p>On Sundays before Bank Holiday Mondays these hours to be extended to 03:45.</p> <p>An additional hour when British Summer Time commences.</p>						

Late Night Refreshment:				Indoors, outdoors or both			Indoors
Day:	Mon	Tues	Wed	Thur	Fri	Sat	Sun
Start:	23:00	23:00	23:00	23:00	23:00	23:00	23:00
End:	01:45	01:45	01:45	03:45	03:45	03:45	01:15
Seasonal variations/ Non-standard timings:			<p>These hours to be extended from the end of permitted hours on New Year's Eve to the start of permitted hours on New Year's Day.</p> <p>On Sundays before Bank Holiday Mondays these hours to be extended to 03:45.</p> <p>An additional hour when British Summer Time commences.</p>				

Sale by retail of alcohol				On or off sales or both:			On
Day:	Mon	Tues	Wed	Thur	Fri	Sat	Sun
Start:	10:00	10:00	10:00	10:00	10:00	10:00	10:00
End:	01:00	01:00	01:00	03:00	03:00	03:00	00:30
Seasonal variations/ Non-standard timings:			<p>These hours to be extended from the end of permitted hours on New Year's Eve to the start of permitted hours on New Year's Day.</p> <p>On Sundays before Bank Holiday Mondays these hours to be extended to 03:00.</p> <p>An additional hour when British Summer Time commences.</p>				

Hours premises are open to the public							
Day:	Mon	Tues	Wed	Thur	Fri	Sat	Sun
Start:	09:00	09:00	09:00	09:00	09:00	09:00	09:00
End:	01:45	01:45	01:45	03:45	03:45	03:45	01:15
Seasonal variations/ Non-standard timings:			<p>These hours to be extended from the end of permitted hours on New Year's Eve to the start of permitted hours on New Year's Day.</p> <p>On Sundays before Bank Holiday Mondays these hours to be extended to 03:45.</p> <p>An additional hour when British Summer Time commences.</p>				
Adult Entertainment:			None.				

2. Representations

2-A Other Persons	
Name:	Colleen Sanders
Address and/or Residents Association:	Flat 2 19 Irving Street WC2H 7AE
Received:	21 st April 2016
<p>STORM NIGHT CLUB is a disgrace to Leicester Square. Please how can I object?</p> <p>This night club attracts a VERY rough and rowdy alcohol induced clientele. I believe it will also have a long history of police activity.</p> <p>Every week (and sometimes several) it seems the police are called to break up a fights & disturbances outside this venue (perhaps more so in the summer). They have an incredible late licence in which after closing (and weather permitting), their clientele will loiter for hours on end and cause much disturbance to the residents effecting my sleep nearly every night and definitely every weekend & bank holiday. It is unbelievable.</p> <p>Living on the square does have its difficulties but this club goes beyond just difficult. They seem to have no boundaries or care for the community.</p>	

3. Policy & Guidance

The following policies within the City Of Westminster Statement of Licensing Policy apply:	
Policy CIP1 applies	<p>(i) It is the Licensing Authoritys policy to refuse applications in the Cumulative Impact Areas for: pubs and bars, fast food premises, and premises offering facilities for music and dancing; other than applications to vary hours within the Core Hours under Policy HRS1.</p> <p>(ii) Applications for other licensable activities in the Cumulative Impact Areas will be subject to other policies, and must demonstrate that they will not add to cumulative impact in the Cumulative Impact Areas.</p>
Policy HRS1 applies	<p>(i) Applications for hours within the core hours set out below in this policy will generally be granted, subject to not being contrary to other policies in the Statement of Licensing Policy.</p> <p>(ii) Applications for hours outside the core hours set out below in this policy will be considered on their merits, subject to other relevant policies.</p>
Policy MD2 applies	It is the Licensing Authoritys policy to refuse applications in the Cumulative Impact Areas, other than applications to vary

	hours within the Core Hours, under Policy HRS1.
Policy PB2 applies	It is the Licensing Authority's policy to refuse applications in the Cumulative Impact Areas other than applications to vary hours within the Core Hours under Policy HRS1.

4. Appendices

Appendix 1	Premises plans
Appendix 2	Applicant supporting documents
Appendix 3	Premises history
Appendix 4	Proposed conditions
Appendix 5	Residential map and list of premises in the vicinity

Report author:	Mr Darren O'Leary Senior Licensing Officer
Contact:	Telephone: 02076417824 Email: doleary@westminster.gov.uk

If you have any queries about this report or wish to inspect one of the background papers please contact the report author.

Background Documents – Local Government (Access to Information) Act 1972

1	Licensing Act 2003	N/A
2	City of Westminster Statement of Licensing Policy	7 th January 2016
3	Amended Guidance issued under section 182 of the Licensing Act 2003	March 2015
4	Application Form	5 th April 2016
5	11/07005/LIPDPS Current premises licence	5 th May 2014
6	Representation – Colleen Sanders	21 st April 2016
7	Email – Agent inviting Colleen Sanders to meet CEO of Dirty Martini to have a tour of the venue.	9 th June 2016
8		
9		
10		
11		
12		
13		
14		
15		
16		
17		
18		
19		
20		
21		
22		
23		
24		

Proposed Basement Floor Plans

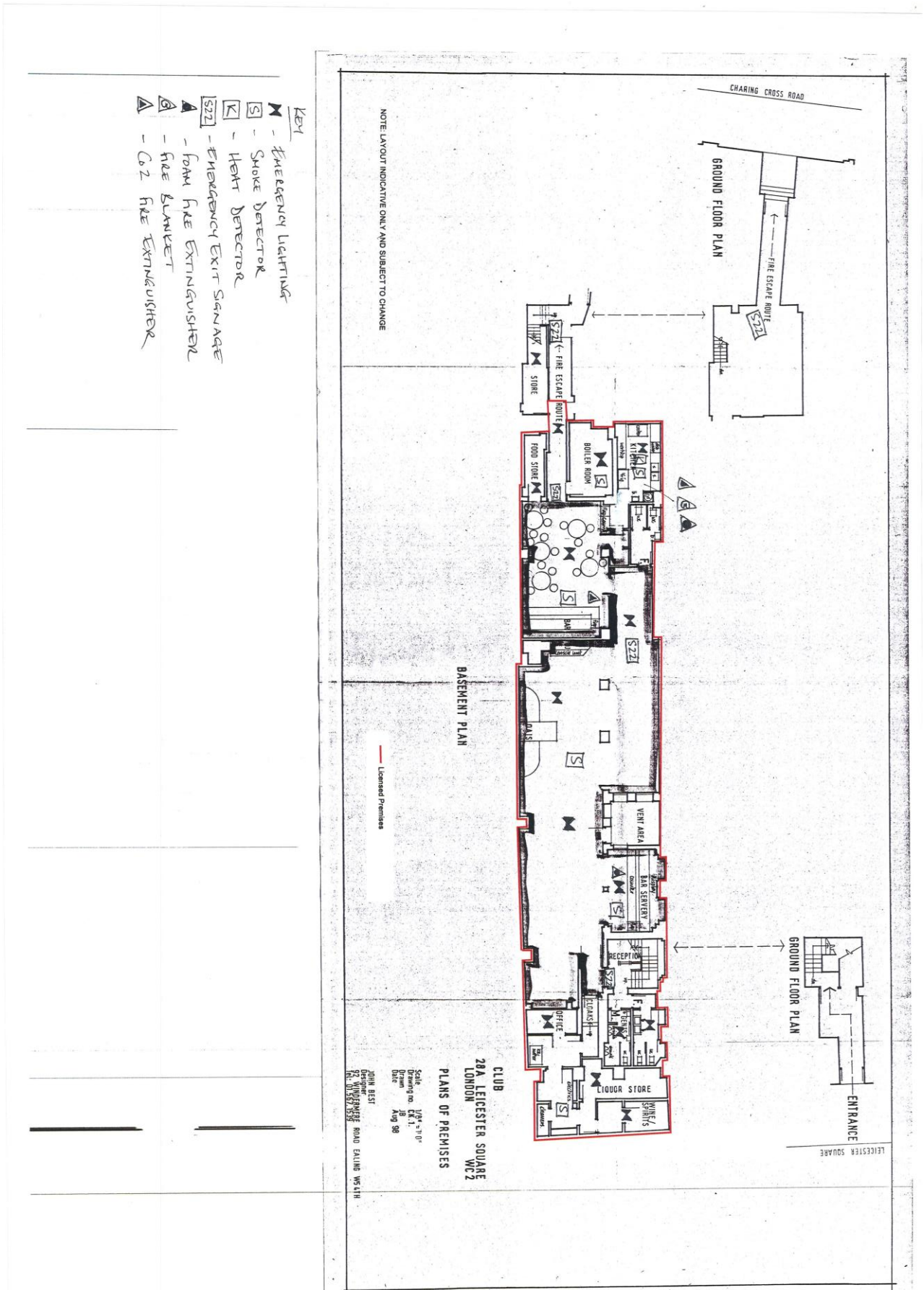

Your ref: 16/03431/LIPN
Our ref: JS/DCB.1.11

38a Monmouth Street
London WC2H 9EP
tel: 020 7042 0410
fax: 020 7379 6618

Premises Licensing
City of Westminster
64 Victoria Street
London
SW1E 6QP

By email: licensing@westminster.gov.uk

14 June 2016

Dear Sirs

Licensing Act 2003
Application for a Premises Licence reference 16/03431/LIPN
Dirty Martini, 28a Leicester Square, WC2H 7LE (the "Premises")

We refer to our client's application and the hearing scheduled 27 June 2016. We would be grateful for the inclusion of this letter and enclosures in the Licensing Sub-Committee's report.

The premises currently operates as "Club Storm" nightclub under Premises Licence 11/07005/LIPDPS. Our client has applied for a new Premises Licence. If granted on satisfactory terms, our client would be in a position to enter a lease and transform the Premises into a premium cocktail bar called "Dirty Martini".

Our client is an extremely experienced, professional and responsible operator. They successfully manage seven Dirty Martini premises across London, as well as two restaurants in Covent Garden. Two Dirty Martini bars are located in Westminster, in Hanover Square and the Covent Garden Piazza. Our client enjoys excellent working relationships with its Licensing Authorities and the Responsible Authorities. We enclose a copy of our client's comprehensive management procedures. These procedures will be implemented at the Premises to ensure the promotion of all four Licensing Objectives.

The application includes a tracked changed version of the current Premise Licence setting out the differences between the existing Licence and that proposed by our client. In summary, the headline changes include:

1. A reduction in the terminal hour for the sale of alcohol from 3.00 am to 1.00 am Monday to Wednesday.

2. An associated reduction in the terminal hour for Regulated Entertainment and Late-Night Refreshment seven days a week, notably a reduction in Regulated Entertainment from 6.00 am to 3.45 am on Thursdays to Saturdays.
3. An increase in the permitted capacity from 235 to 300 (excluding staff).
4. An update of the operating schedule. This includes subsequent changes and additional conditions following consultation with the Environmental Health Consultation Team (EHCT) and Metropolitan Police.

We enclose a schedule of final conditions agreed with the EHCT and Metropolitan Police for reference.

The application received a single objection from a local resident, Ms Colleen Sanders. Ms Sanders' concerns solely relate to the operation of the Premises as Club Storm nightclub. We have engaged with Ms Sanders to provide reassurances that the applicant is not connected with Club Storm in any way whatsoever. We enclose a copy of our correspondence with Ms Sanders accordingly.

The Premises is within the West End Cumulative Impact Area and an increase in capacity is proposed. However, in accordance with the City Council's Statement of Licensing Policy 2016, we submit the following exceptions apply:

1. The Premises has historically operated as late-night venue and currently benefits from Premises Licence 11/07005/LIPDPS. This established Premises Licence authorises licensable activities as late as 6.00 am. The current application represents the substitution of an existing nightclub operation and extremely late licence with a less intrusive licensed use operated by an exemplary and professional Premises Licence holder. This substitution is consistent with the exception identified in paragraph 2.4.7 of the Policy.
2. The application proposes significant reductions in the terminal hours for licensable activities seven days a week. This is directly compliant with another exception identified in paragraph 2.4.7 of the Policy which states *"a reduction in hours of operation might be a reason for an exception to policy"*.
3. In addition to the exceptions above, updated and stringent new licence conditions. This includes new requirements for SIA supervision, search policies and restrictions on the number of smokers etc.

As a result of the above, our client can demonstrate the application will make no global addition to the Cumulative Impact. The reduction in terminal hours and change of user should, in fact, present a reduction in the Cumulative Impact currently experienced in the West End.

The completion of our client's lease of the Premises is conditional upon a satisfactory Premises Licence being granted. As confirmed by Ms Sanders, the current late-night nightclub operation of the Premises has a chequered past and is adversely impacting upon the Licensing Objectives.

Our client hopes the Licensing Sub-Committee will see the application as an opportunity to replace the current use with a high-class and responsible operator trading with an earlier terminal hour. In addition, our client submits the improved use of the Premises will help contribute to the City Council's wider objective of revitalising and improving Leicester Square and the surrounding area.

Jack Spiegler of these offices will attend the hearing with Mr Scott Matthews, CEO of the applicant company, to address the Licensing Sub-Committee further. Proposed layout plans are now ready and can be presented

to the Committee if required. These plans will be subject to a future variation application, should the current application be granted.

Thank you for your consideration of this letter.

Yours faithfully

Jack Spiegler
Thomas & Thomas Partners LLP
tel: 020 7042 0413
email: jspiegler@tandtp.com

Encl.

Licence & Appeal History

Application	Details of Application	Date Determined	Decision
Conversion Application 05/06235/LIPCV	Application to convert the Justices' Restaurant Licence	18.09.2005	Conversion deemed Granted
Vary DPS Application 10/04128/LIPDPS	Application to vary the Designated Premises Supervisor to Justin Wallace	19.08.2010	Granted Under Delegated Authority
Vary DPS Application 10/10495/LIPDPS	Application to vary the Designated Premises Supervisor to Obiora Anthony Megafu	31.12.2010	Granted Under Delegated Authority
Vary DPS Application 11/07005/LIPDPS	Application to vary the Designated Premises Supervisor to Obiora Anthony Megafu	26.07.2011	Granted Under Delegated Authority
Variation Application 14/02814/LIPV	Application to Vary the following : This application seeks to: - Increase the hours for the retail sale of alcohol on Sundays from 00:30 am to 02:00 am - Decrease the hours for the dancing, live music and anything similar on Thursdays and Fridays from 06:00 am to 05:am - Add conditions as set out in the operating schedule. - Delete condition 18 and update with WCC's model CCTV condition as per the operating schedule - Delete condition 25 and 26 as superfluous	19.06.2014	Application Refused

	- Reduce the opening hours on Thursdays and Fridays from 06:00 am to 5:00 am.		
--	---	--	--

There is no appeal history

CONDITIONS CONSISTENT WITH THE OPERATING SCHEDULE AND CONDITIONS PROPOSED BY A PARTY TO THE HEARING

When determining an application for a new premises licence under the provisions of the Licensing Act 2003, the licensing authority must, unless it decides to reject the application, grant the licence subject to the conditions which are indicated as mandatory in this schedule.

At a hearing the licensing authority may, in addition, and having regard to any representations received, grant the licence subject to such conditions which are consistent with the operating schedule submitted by the applicant as part of their application, or alter or omit these conditions, or add any new condition to such extent as the licensing authority considers necessary for the promotion of the licensing objectives.

This schedule lists those conditions which are consistent with the operating schedule, or proposed as necessary for the promotion of the licensing objectives by a responsible authority or an interested party as indicated. These conditions have not been submitted by the licensing service but reflect the positions of the applicant, responsible authority or interested party and have not necessarily been agreed

Mandatory Conditions

1. No supply of alcohol may be made at a time when there is no designated premises supervisor in respect of this licence.
2. No supply of alcohol may be made at a time when the designated premises supervisor does not hold a personal licence or the personal licence is suspended.
3. Every supply of alcohol under this licence must be made or authorised by a person who holds a personal licence.
4.
 - (1) The responsible person must ensure that staff on relevant premises do not carry out, arrange or participate in any irresponsible promotions in relation to the premises.
 - (2) In this paragraph, an irresponsible promotion means any one or more of the following activities, or substantially similar activities, carried on for the purpose of encouraging the sale or supply of alcohol for consumption on the premises—
 - (a) games or other activities which require or encourage, or are designed to require or encourage, individuals to;
 - (i) drink a quantity of alcohol within a time limit (other than to drink alcohol sold or supplied on the premises before the cessation of the period in which the responsible person is authorised to sell or supply alcohol), or
 - (ii) drink as much alcohol as possible (whether within a time limit or otherwise);
 - (b) provision of unlimited or unspecified quantities of alcohol free or for a fixed or discounted fee to the public or to a group defined by a particular characteristic in a manner which carries a significant risk of undermining a licensing objective;
 - (c) provision of free or discounted alcohol or any other thing as a prize to encourage or reward the purchase and consumption of alcohol over a period of 24 hours or

less in a manner which carries a significant risk of undermining a licensing objective;

- (d) selling or supplying alcohol in association with promotional posters or flyers on, or in the vicinity of, the premises which can reasonably be considered to condone, encourage or glamorise anti-social behaviour or to refer to the effects of drunkenness in any favourable manner;
 - (e) dispensing alcohol directly by one person into the mouth of another (other than where that other person is unable to drink without assistance by reason of a disability).
5. The responsible person must ensure that free potable water is provided on request to customers where it is reasonably available.
6. (1) The premises licence holder or club premises certificate holder must ensure that an age verification policy is adopted in respect of the premises in relation to the sale or supply of alcohol.
- (2) The designated premises supervisor in relation to the premises licence must ensure that the supply of alcohol at the premises is carried on in accordance with the age verification policy.
- (3) The policy must require individuals who appear to the responsible person to be under 18 years of age (or such older age as may be specified in the policy) to produce on request, before being served alcohol, identification bearing their photograph, date of birth and either—
- (a) a holographic mark, or
 - (b) an ultraviolet feature.
7. The responsible person must ensure that—
- (a) where any of the following alcoholic drinks is sold or supplied for consumption on the premises (other than alcoholic drinks sold or supplied having been made up in advance ready for sale or supply in a securely closed container) it is available to customers in the following measures—
 - (i) beer or cider: ½ pint;
 - (ii) gin, rum, vodka or whisky: 25 ml or 35 ml; and
 - (iii) still wine in a glass: 125 ml;
 - (b) these measures are displayed in a menu, price list or other printed material which is available to customers on the premises; and
 - (c) where a customer does not in relation to a sale of alcohol specify the quantity of alcohol to be sold, the customer is made aware that these measures are available.

A responsible person in relation to a licensed premises means the holder of the premise licence in respect of the premises, the designated premises supervisor (if any) or any individual aged 18 or over who is authorised by either the licence holder or designated premises supervisor. For premises with a club premises certificate, any member or officer of the club present on the premises in a capacity that which enables him to prevent the supply of alcohol.

8(i) A relevant person shall ensure that no alcohol is sold or supplied for consumption on or off the premises for a price which is less than the permitted price.

8(ii) For the purposes of the condition set out in paragraph 8(i) above -

(a) "duty" is to be construed in accordance with the Alcoholic Liquor Duties Act 1979;

(b) "permitted price" is the price found by applying the formula -

$$P = D + (D \times V)$$

Where -

(i) P is the permitted price,

(ii) D is the amount of duty chargeable in relation to the alcohol as if the duty were charged on the date of the sale or supply of the alcohol, and

(iii) V is the rate of value added tax chargeable in relation to the alcohol as if the value added tax were charged on the date of the sale or supply of the alcohol;

(c) "relevant person" means, in relation to premises in respect of which there is in force a premises licence -

(i) the holder of the premises licence,

(ii) the designated premises supervisor (if any) in respect of such a licence, or

(iii) the personal licence holder who makes or authorises a supply of alcohol under such a licence;

(d) "relevant person" means, in relation to premises in respect of which there is in force a club premises certificate, any member or officer of the club present on the premises in a capacity which enables the member or officer to prevent the supply in question; and

(e) "value added tax" means value added tax charged in accordance with the Value Added Tax Act 1994.

8(iii). Where the permitted price given by Paragraph 8(ii)(b) above would (apart from this paragraph) not be a whole number of pennies, the price given by that sub-paragraph shall be taken to be the price actually given by that sub-paragraph rounded up to the nearest penny.

8(iv). (1) Sub-paragraph 8(iv)(2) below applies where the permitted price given by Paragraph 8(ii)(b) above on a day ("the first day") would be different from the permitted price on the next day ("the second day") as a result of a change to the rate of duty or value added tax.

(2) The permitted price which would apply on the first day applies to sales or supplies of alcohol which take place before the expiry of the period of 14 days beginning on the second day.

Conditions consistent with the operating schedule

9. The premises may remain open for the provision of licensable activities from the terminal hour for those activities on New Year's Eve through to the commencement time for those activities on New Year's Day.
10. On the morning that Greenwich Mean Time changes to British Summer Time one hour will be added to the terminal hour of any activities and to the closing time for the premises where the existing terminal hour for the activities and/or closing hour for the premises ends after 01.00.
11. Cloakroom facilities shall be available at all times the premises is open to members of the public.
12. The number of persons accommodated at any one time in the premises shall not exceed 300 (excluding staff).
13. Substantial food and suitable beverages other than intoxicating liquor (including drinking water) shall be available during the whole of the permitted hours in all parts of the premises where intoxicating liquor is sold or supplied.
14. At least one personal licence holder shall be present during the whole time intoxicating liquor is supplied, sold or consumed.
15. There shall be no striptease or nudity, and all persons shall be decently attired at all times, except when the premises are operating under the authority of a Sexual Entertainment Venue licence.
16. There shall be no payment made by or on behalf of the licensees to any person for bringing customers to the premises.
17. If any entertainment is provided for children or if an entertainment is provided at which the majority of persons attending are children, then, if the number of children attending the entertainment exceeds 100, it shall be the duty of the holder of this premises licence / club premises certificate:
 - a) to station and keep stationed wherever necessary a sufficient number of adult attendants, properly instructed as to their duties, to prevent more children or other persons being admitted to the building, or to any part thereof, than the building or part can properly accommodate,
 - b) to control the movement of the children and other persons admitted while entering and leaving the building or any part thereof, and
 - c) to take all other reasonable precautions for the safety of the children.
18. The premises shall install and maintain a comprehensive CCTV system as per the minimum requirements of the Westminster Police Licensing Team. All entry and exit points will be covered enabling frontal identification of every person entering in any light condition. The CCTV system shall continually record whilst the premises is open for licensable activities and during all times when customers remain on the premises. All recordings shall be stored for a minimum period of 31 days with the date and time stamping. Viewing of recordings shall be made available immediately upon the request of Police or authorised officer through the preceding 31 day period.
19. A staff member from the premises who is conversant with the operation of the CCTV system shall be on the premises at all times when the premises is open. This staff member must be able to provide a Police or authorised council officer, with copies of recent CCTV images or data with the absolute minimum of delay when requested.

20. After 8pm all staff engaged outside the entrance to the premises, or supervising or controlling queues, shall wear high visibility yellow jackets or vests.
21. An incident log shall be kept at the premises and made available on request to an authorised officer of the City Council or the Police, which will record the following:
 - (a) All crimes reported to the venue
 - (b) All ejections of patrons
 - (c) Any complaints received concerning crime and disorder
 - (d) Any incidents of disorder
 - (e) All seizures of drugs or offensive weapons
 - (f) Any faults in the CCTV system or searching equipment or scanning equipment
 - (g) Any refusal of the sale of alcohol
 - (h) Any visit by a relevant authority or emergency service
22. Patrons permitted to temporarily leave and then re-enter the premises, e.g. to smoke, shall not be permitted to take drinks or glass containers with them.
23. Except for persons temporarily leaving the premises to smoke, there shall be no entry to the premises after 01:30am on Thursdays to Saturdays.
24. The Licence will have no effect until the works shown on the plans (or subsequently submitted plans) have been assessed as satisfactory by the Environmental Health Consultation Team at which time this condition shall be removed from the Licence by the Licensing Authority - if there are minor layout changes during the course of construction new plans shall be submitted.

Conditions agreed with environmental health

25. The approved arrangements at the premises, including means of escape provisions, emergency warning equipment, the electrical installation and mechanical equipment, shall at all material times be maintained in good condition and full working order.
26. The means of escape provided for the premises shall be maintained unobstructed, free of trip hazards, be immediately available and clearly identified in accordance with the plans provided.
27. All emergency exit doors shall be available at all material times without the use of a key, code, card or similar means.
28. All emergency doors shall be maintained effectively self-closing and not held open other than by an approved device.
29. The edges of the treads of steps and stairways shall be maintained so as to be conspicuous.
30. Curtains and hangings shall be arranged so as not to obstruct emergency safety signs or emergency equipment.
31. All fabrics, curtains, drapes and similar features including materials used in finishing and furnishing shall be either non-combustible or be durably or inherently flame-retarded fabric. Any fabrics used in escape routes (other than foyers), entertainment areas or function rooms, shall be non-combustible.

Conditions agreed with Metropolitan Police

32. A minimum of 2 SIA licensed door supervisors (increasing to a ratio of 1:100 customer capacity) shall be on duty from 2000 until close Thursday to Saturday inclusive.
33. The premises shall operate a search on entry policy subject to an operational risk assessment.
34. Patrons permitted to temporarily leave and then re-enter the premises, e.g. to smoke, shall not be permitted to take drinks or glass containers with them.
35. Notices shall be prominently displayed at any area used for smoking requesting patrons to respect the needs of local residents and use the area quietly.



Dirty Martini, 28A Leicester Square, London WC2H 7LE

City of Westminster

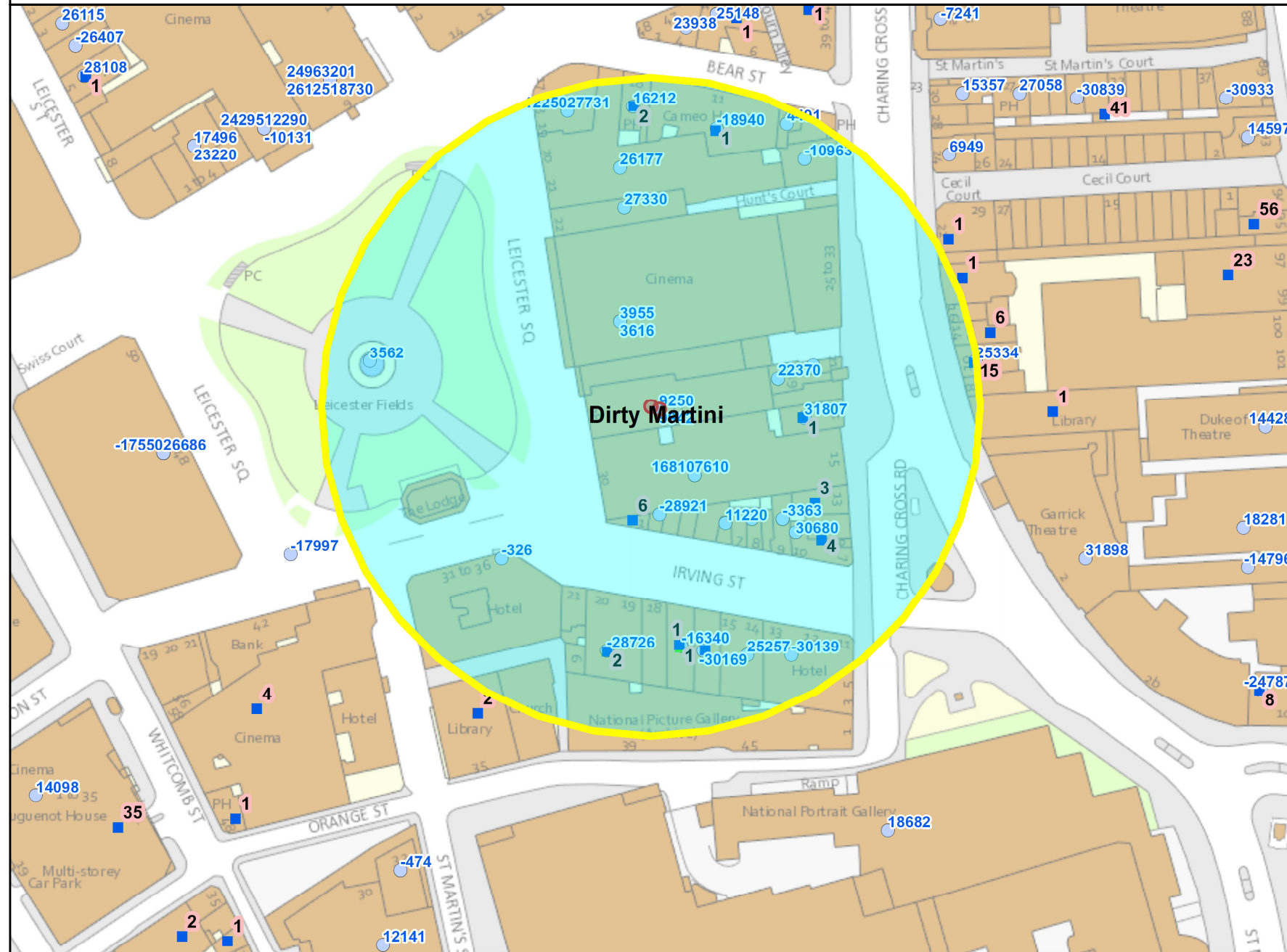

Residential / Proposed Residential	37
Under Construction	Not known
Other Uses	Not known
Proportion Residential of all Uses	Not known

10
 Meters

This product includes mapping data licensed from Ordnance Survey with the permission of the Controller of Her Majesty's Stationery Office. © Crown copyright and/or database right 2013. All rights reserved. Licence number LA 100019597

Data Source: Uniform Database
 Date: 17/06/2016

Premises within 75 metres of: Dirty Martini, 28A Leicester Square, London WC2H 7LE

p / n	Name of Premises	Premises Address	Opening Hours
3616	Odeon Cinema	24-27 Leicester Square London WC2H 7LE	Monday to Sunday 00:00 - 00:00
4491	Bear & Staff Public House	10-12 Bear Street London WC2H 7AS	Friday to Saturday 07:00 - 00:00 Sunday 07:00 - 00:00 Sundays before Bank Holidays 07:00 - 00:00 Monday to Saturday 07:00 - 00:30 Sunday 07:00 - 22:30 Monday to Thursday 07:00 - 23:30
16810	Global Radio	29-30 Leicester Square London WC2H 7LA	Monday to Friday 07:00 - 00:00
26177	Chiquitos	20-21 Leicester Square London WC2H 7LE	Sunday 08:00 - 00:00 Monday to Wednesday 08:00 - 00:30 Thursday to Saturday 08:00 - 01:00
31807	Lotus	17 Charing Cross Road London WC2H 0EP	Monday to Sunday 10:00 - 00:30
-30139	Steak & Co	Ground Floor 3 - 5 Charing Cross Road London WC2H 0HA	Monday to Saturday 10:00 - 00:30 Sunday 12:00 - 00:00
-15602	Wox	8 Irving Street London WC2H 7AT	Monday to Saturday 23:00 - 05:00
9942	Club Storm	28A Leicester Square London WC2H 7LE	Sunday 09:00 - 02:00 Sundays before Bank Holidays 09:00 - 02:30 Monday to Wednesday 09:00 - 03:30 Thursday to Saturday 09:00 - 06:00
16212	Zoo Too	18 Bear Street London WC2H 7AS	Monday to Wednesday 10:00 - 00:00 Thursday 10:00 - 01:00 Friday to Saturday 10:00 - 02:00 Sunday 12:00 - 23:00
22370	Maharaja Of India	19A Charing Cross Road London WC2H 0ES	Monday to Saturday 10:00 - 23:30 Sunday 12:00 - 23:00
25257	Wagamama	14A Irving Street London WC2H 7AU	Monday to Saturday 10:00 - 00:30 Sunday 12:00 - 00:00
25334	The Garrick Arms	8-10 Charing Cross Road London WC2H 0HG	Friday to Saturday 08:00 - 00:00 Sundays before Bank Holidays 08:00 - 00:00 Sunday 08:00 - 22:30 Monday to Thursday 08:00 - 23:30
30680	Bella Italia	10 Irving Street London WC2H 7AT	Sunday 09:00 - 00:00 Monday to Saturday 09:00 - 01:00 Sundays before Bank Holidays 09:00 - 01:00
-31802	Fornetto	21 Charing Cross Road London WC2H 0ES	Monday to Sunday 11:00 - 03:00
-30169	Wild Tree	Ground Floor 16 Irving Street London WC2H 7AU	Monday to Saturday 10:00 - 00:30 Sunday 12:00 - 00:00
-28921	Stephano's Cafe La Chandelle	2-3 Irving Street London WC2H 7AT	Sunday 08:00 - 00:00 Monday to Saturday 08:00 - 00:30
-28726	Garfunkel's Restaurants	Ground Floor 19-20 Irving Street London WC2H 7AU	Monday to Saturday 10:00 - 00:30 Sunday 12:00 - 00:00
-16340	Caffe Concerto	17 - 18 Irving Street London WC2H 7AU	Sunday 07:00 - 00:00 Monday to Saturday 07:00 - 00:30 Christmas Eve 07:00 - 02:30 New Year's Eve 07:00 - 07:00
-14723	Pompidou	9A Irving Street London WC2H 7AT	Monday to Saturday 07:00 - 23:30 Sunday 09:00 - 23:00
-12250	Burger King	17-18 Leicester Square London WC2H 7LE	Monday to Sunday 23:00 - 03:00
-18940	The Zoo Bar And Club	Basement And Ground Floor Cameo House 13-17 Bear Street London WC2H 7AQ	Sunday 09:00 - 01:00 Monday to Saturday 09:00 - 02:30 Sundays before Bank Holidays 09:00 - 02:30 Monday to Saturday 09:00 - 03:30
-10963	K. S. Food And Wine	Ground Floor 35 Charing Cross Road London WC2H 0AT	Monday to Sunday 08:00 - 05:00
-3363	Beefsteak Club	Basement To First Floor 9 Irving Street London WC2H 7AT	Monday to Friday 13:00 - 15:00 Monday to Friday 17:30 - 23:30
-326	Radisson Hampshire Hotel	31-36 Leicester Square London WC2H 7LH	Monday to Sunday 00:01 - 00:00
3562	Leicester Square Gardens	Open Space At Leicester Square London WC2H 7LE	Monday to Saturday 07:30 - 22:30 Sunday 08:00 - 22:30

3955	Odeon Cinema	24-27 Leicester Square London WC2H 7LE	Monday to Sunday 00:00 - 00:00
9250	Moon Under Water	28 Leicester Square London WC2H 7LE	Friday to Saturday 07:00 - 00:00 Sundays before Bank Holidays 07:00 - 00:00 Sunday 07:00 - 22:50 Monday to Thursday 07:00 - 23:30
7610	TGI Fridays	29-30 Leicester Square London WC2H 7LA	Sunday 09:00 - 01:00 Monday to Saturday 09:00 - 01:30 Sundays before Bank Holidays 09:00 - 01:30
11220	El Padrino	6-7 Irving Street London WC2H 7AT	Monday to Saturday 10:00 - 01:30 Sunday 11:00 - 01:30
27731	Pizza Hut	19 Leicester Square London WC2H 7LE	Monday to Thursday 10:00 - 02:00 Friday to Saturday 10:00 - 05:00 Sunday 12:00 - 02:00
27330	Bella Italia	22 Leicester Square London	Sunday 09:00 - 00:00 Monday to Saturday 09:00 - 01:00 Sundays before Bank Holidays 09:00 - 01:00